

Allergen management with bioavid lateral flow tests

Reliable allergen analysis and identification of also high positive samples



Perfect for cleaning controls



Direct analysis of rinse water samples (CIP water)



Versatile – also applicable for food testing

More information:



https://r-b.io/bioavid_EN

Allergen management with bioavid lateral flow tests

To prevent allergic reactions in sensitive persons, food production lines and the food itself have to be free of residues. Lateral flow tests are a simple and fast technique to detect the presence or absence of allergens.

Advantages



Hook line included to detect false negative results



Everything included for hygiene testing



Validated for selected foods



Fast and reliable results in 10 minutes



Suitable for everyone – even for non-laboratory staff

The hook effect

The hook effect (or “overload” effect; Standard EN 15633-1. 2019) is observed when a very high amount of an analyte is present in the sample. In this case, the analyte’s amount exceeds the amount of color-labelled antibodies and the ratio between both needed for the formation of the test band becomes imbalanced.

Although the analyte is present, only a faint or even no test band is visible. Hence, there is risk for a falsely low or negative interpretation of a test result. This effect becomes visible by the hook line. A missing hook line indicates high allergen content in a sample. In this case, test users must not interpret a missing test line as negative.

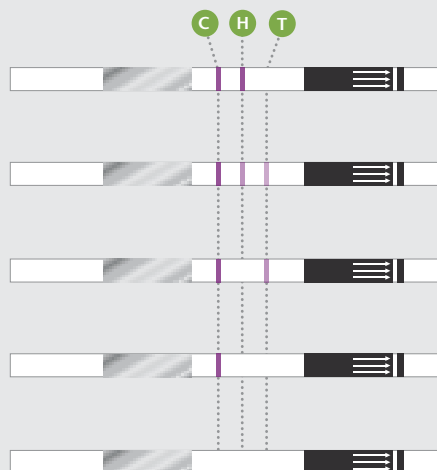

C-line and H-line present, no T-line:
valid negative result

All 3 lines present: valid positive result

C-line and T-line present, H-line faint or absent:
valid high positive result

Only C-line present: suspected high positive,
repeat test with higher sample dilution

No C-line: test is invalid

bioavid – test procedure BLH series

1 Sample preparation

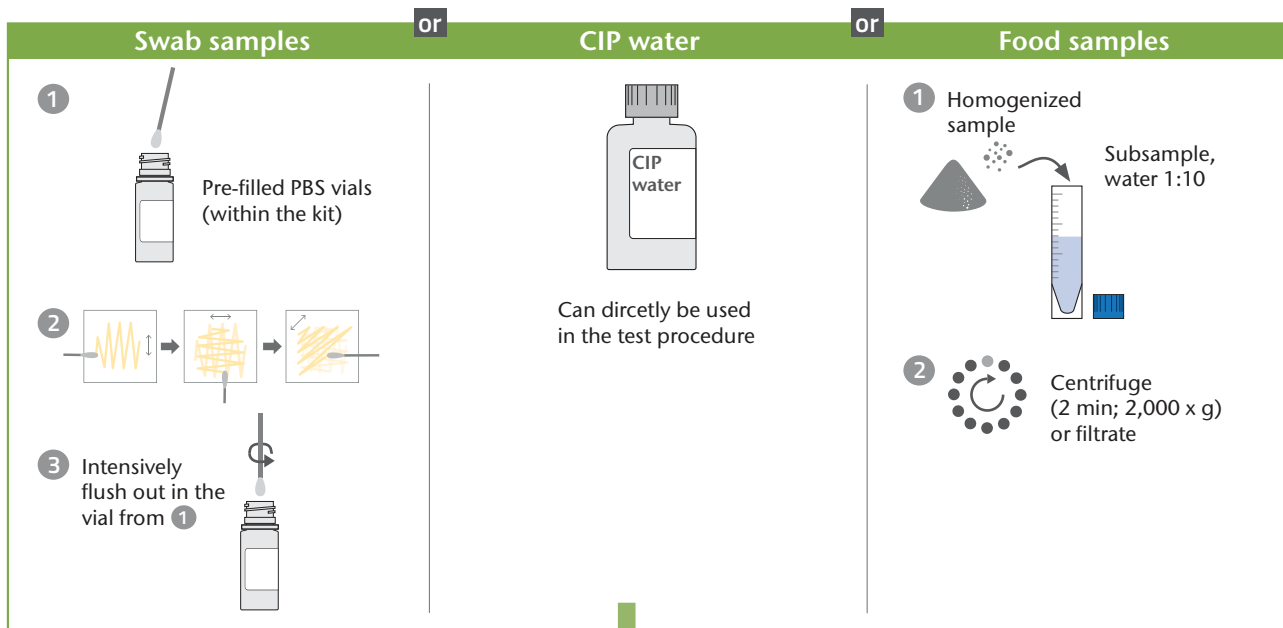

2 Test procedure

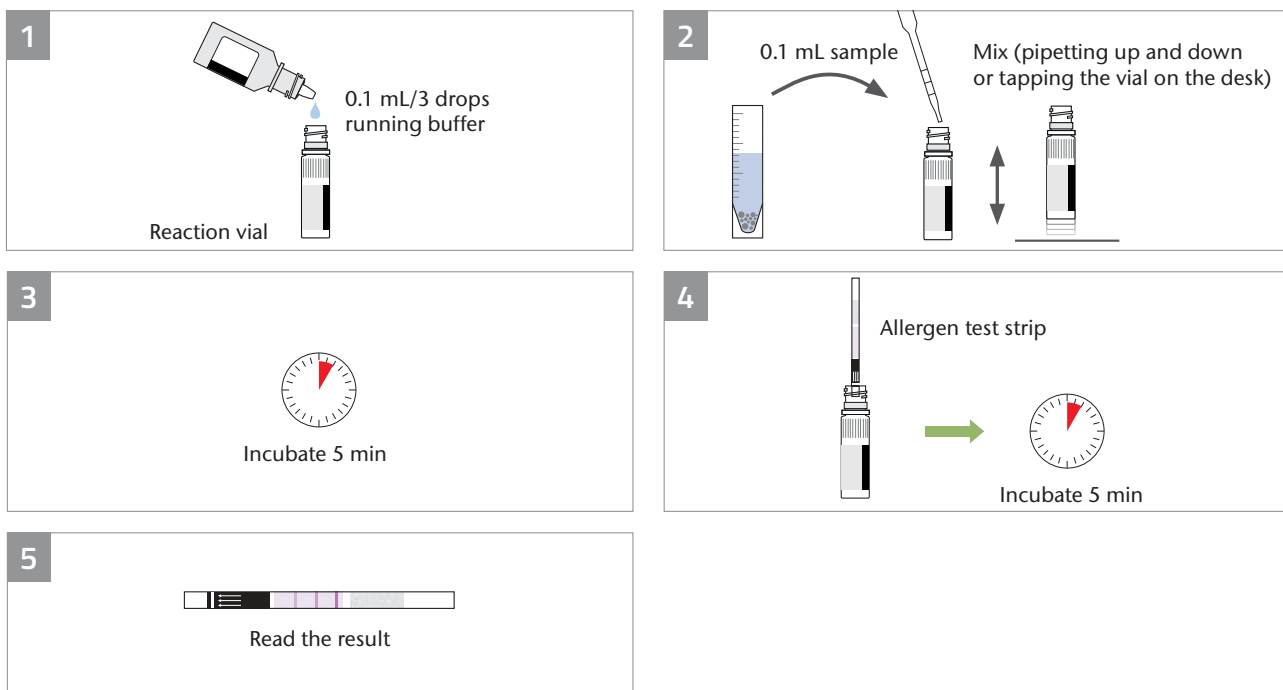

bioavid – product overview

With hook line

Product	Description	No. of tests/amount	Art. No.
Coconut			
Lateral Flow Coconut incl. Hook Line	Qualitative detection of coconut residues	15 strips	BLH700-15
Almond			
Lateral Flow Almond incl. Hook Line	Qualitative detection of almond residues	15 strips	BLH701-15
Brazil nut			
Lateral Flow Brazil nut incl. Hook Line*	Qualitative detection of brazil nut residues	15 strips	BLH702-15
Mustard			
Lateral Flow Mustard incl. Hook Line	Qualitative detection of mustard residues	15 strips	BLH703-15
Hazelnut			
Lateral Flow Hazelnut incl. Hook Line	Qualitative detection of hazelnut residues	15 strips	BLH704-15
Macadamia			
Lateral Flow Macadamia incl. Hook Line*	Qualitative detection of macadamia residues	15 strips	BLH705-15
Peanut			
Lateral Flow Peanut incl. Hook Line	Qualitative detection of peanut residues	15 strips	BLH706-15
Walnut			
Lateral Flow Walnut incl. Hook Line*	Qualitative detection of walnut residues	15 strips	BLH707-15
Egg			
Lateral Flow Egg incl. Hook Line	Qualitative detection of egg residues	15 strips	BLH708-15
Sesame			
Lateral Flow Sesame incl. Hook Line	Qualitative detection of sesame residues	15 strips	BLH709-15
Cashew			
Lateral Flow Cashew incl. Hook Line	Qualitative detection of cashew residues	15 strips	BLH710-15
Pistachio			
Lateral Flow Pistachio incl. Hook Line*	Qualitative detection of pistachio residues	15 strips	BLH711-15
Casein			
Lateral Flow Casein incl. Hook Line	Qualitative detection of casein residues	15 strips	BLH714-15
Crustacean			
Lateral Flow Crustacean incl. Hook Line	Qualitative detection of crustacean residues	15 strips	BLH716-15

In addition to our tests with hook line, we also offer the following tests without hook line:

Without hook line

Soy			
Lateral Flow Soy*	Qualitative detection of native soy residues	15 strips	BL612-15
Milk			
Lateral Flow Milk	Qualitative detection of milk residues	15 strips	BL623-15

* soon available